

---

# Instruction

---

INSTALLATION GUIDE AND MAINTENANCE





---

Instruction

---

# Quickstart Preparation, Installation, Maintenance

# Quickstart

## GENERAL

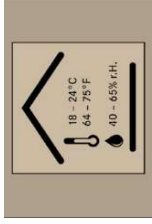

## PREPARATION BEFORE INSTALLATION

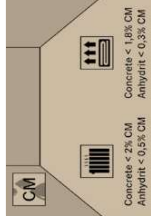
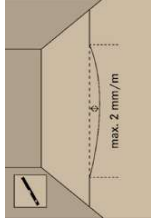

## FLOATING INSTALLATION

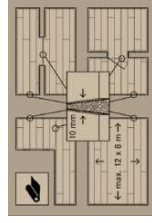
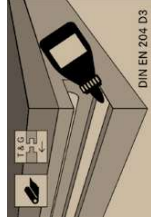
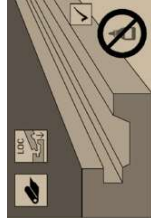
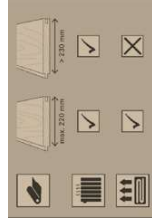

## GLUE DOWN INSTALLATION

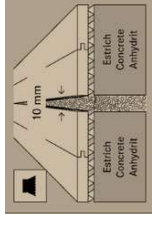
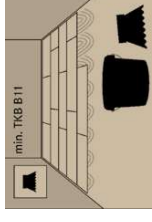
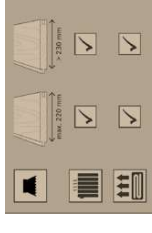

## GENERAL RULES FOR INSTALLATION

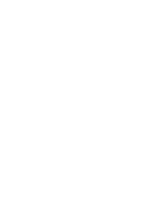
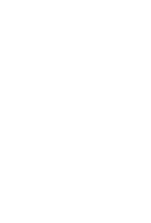
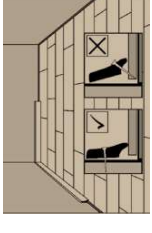
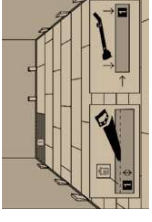
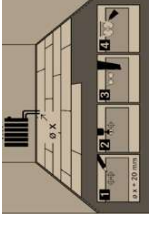
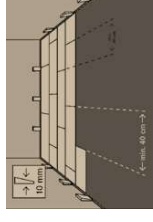
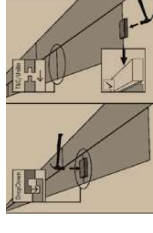
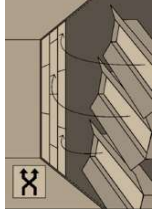
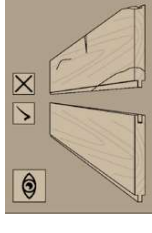

---

## PROTECTION AND CARE

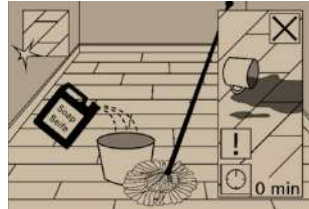
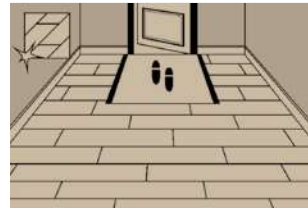
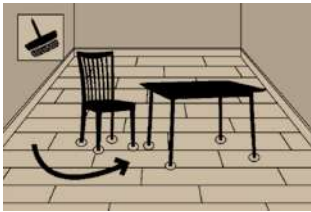

---

## REMARKS

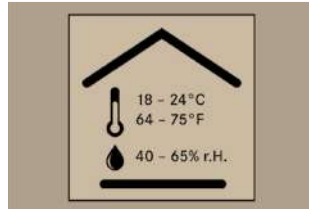
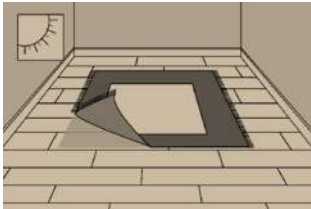



---

Instruction

---

# Preparation

# Preparation

Please read this instruction carefully before installation. Violations may cause damages and waive any warranty.

## APPLICATION

This engineered flooring is designed for layment in regular heated, dry rooms. The profiling on all 4 edges enables a fast and easy installation. It can be laid as a floating floor or glued down to the subfloor. Glue down installation protects against climate driven deformations. The flooring is suitable for installation on watercirculating underfloor heating (radiant heated floor) according to DIN EN 1264 part 3. For a good heat conduction glue down installation is recommended. 22 cm or wider flooring elements must always be glued down over underfloor heating.

## ROOM CLIMATE AND HEATING

All rooms shall be normally heated during installation (minimum 18° C/81° F), the relative humidity must be between 35% and 65%. Excessive moisture during the installation may yield in unexpected tension of the boards. It will normalize after some time.

Maintenance of the correct relative humidity during and after installation reduces the possibility of deformation and the appearance of small openings in the floor. High temperatures from open fireplaces, tiled stoves or intensive sunlight (eg. conservatories) and low humidity may cause open gaps, surface cracks and deformations. During winter there must be appropriate measures taken for air humidification.

Over floor heating the maximum heat output must not exceed 55 W/m<sup>2</sup> and cover the whole surface. The maximum temperature of the surface must never exceed 29° C. Coverage of floor heating systems with thick rugs or other floor covering may lead to unacceptable heat concentration. Climate driven damages and health disturbances can be minimized if the surface temperatures do not exceed 27° C and the air humidity is controlled between 35 – 65%. At the beginning of each heating season the temperature shall be gradually increased evenly over 7 days until normal heating levels are achieved.

## HANDLING OF THE UNOPENED BUNDLES

Engineered flooring elements are precision profiled on all 4 edges and must be handled with care during transport and storage. The original packaging shall be opened immediately prior to installation. During winter months the engineered flooring must remain in unopened packaging for up to 48 hours in order to reach the room temperature.

## SUBFLOOR

The subfloor must be free of any carpets, clean, permanently dry, level, firm and structurally sound. Variations in level of the subfloor of more than 2 mm in 1 m (1/8" in 8') have to be filled or planned. The allowable maximum moisture content of a regular subfloor on a dry weight basis is for concrete 2,0%, for anhydrous screed 0,5% and must be verified before installation. With radiant heating the allowable maximum moisture content of the subfloor on a dry weight basis is for concrete 1,8%, for anhydrous screed 0,3%. The subfloor must be dried out according to the heating protocol for radiant heated subfloors and the moisture content be measured prior to the installation. Subfloors with direct contact to the soil, sections which are over unheated rooms or crawl spaces or with increased humidity loads like boiler or laundry rooms always require additional protection against moisture (vapour barrier).

## SPACING

Wood as a natural material reacts to changes climate. Between the flooring and walls, and all other hard points, such as door frames or heating pipes there must be a horizontal distance of 10 – 12 mm (1/2"). Wherever possible the flooring is laid under the door frames.

## FLOATING INSTALLATION

A moisture barrier of 0,2 mm (6 mil) polyethylene membrane shall be laid directly on the subfloor with approx. 20 cm (8") overlap. The barrier shall go up the walls abt. 5 cm (2"). On a radiant heated floor the overlaps must be taped. The noise protection underlayment of max. 3 mm (1/8") thickness is installed without overlap on top of the moisture barrier.

When installed floating under doorways the flooring must be separated into different segment. Floor segments longer than 12 m (40') or wider than 8 m (26') or complex shaped floor plans (e.g. L-, Z- or U-shaped, hourglass, bottlenecked or in doorways) or where heavy or fixed installations would restrict the free expansion of the material, the floor must be separated with an expansion gap at a suitable position or glued down onto the subfloor.

## GLUE DOWN INSTALLATION

The floor is glued directly on the subfloor. There is no additional glue required between the edges. A vapor barrier primer directly on the subfloor helps to minimize the development of visible openings between the floor elements. We recommend elastic, water- and solvent free adhesives, which are designed for engineered flooring and underfloor heating (radiant heated floor). Please always follow the instructions of the supplier of the adhesive.

Separation gaps between building segments must be copied in the flooring. Other subfloor cuts can be firmly linked and glued over.

## TOOLS

Recommended are measuring tape, pencil, angle ruler and a saw, hammer abt. 500 g, parquet tool, tapping block and wooden distance spacers. For glue down installation additionally a dented trowel (TKB BT) or an adhesive application tool (Parkell-X-Press) and a tapping tool suitable for glue down installation.







---

Instruction

---

# Installation Guide and Maintenance

# Installation

## VISUAL INSPECTION

Wood is a wholly natural product and each piece unique in colour and design. It may be necessary to alternate pieces from different bundles to create a nice visual impression of the floor. Our strict quality control procedures cannot completely eliminate possible defects. Should you find a piece which does not conform to our quality, please return it to the supplier for free exchange. Please check the panels and put defect boards aside. Imperfect and already installed boards cannot be claimed.

## INSTALLATION

The flooring elements are to be installed along a perfect straight line, often simply along a straight wall. There is no rule for the orientation of the boards. In principle any desired direction in the room is possible. Layment in an angle is technically possible, however requires additional time and skills.

Start with the first piece, for tongue and groove with the grooves facing to the wall and the tongue heading into the direction of work progress. For UniClic and DropDown profiles the tongue face to the walls and the groove with the longer bottom part face towards the work direction. Beginning from the starter link board by board into the end and finish a complete row. The last piece in the line is trimmed, side pieces are cut to follow the shape of the wall. Adjacent rows always must have an offset of the ends of min. 40 cm.

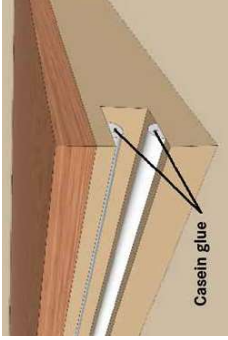

### T&G

Always hit with the tapping block against the tongue. When installed floating glue must be applied in the grooves along the edge and the end (see picture).

### UniClic

Insert the tongue of the long edge in an angle into the preliminary row, fold the board down and secure with some gentle horizontal taps of the block. First against the long, later against the short edge. Additional glue application is possible but not mandatory.

### DropDown

The long edge is folded down as above. The ends are locked into each other during the downfold. Secure the lock of the ends by some gentle hits from above to the face of the board. Additional glue application is also possible but not mandatory.

During installation the expansion gap to all walls is secured with the wooden spacers. After the last floor element is installed, remove all spacers. Trim remainings of the vapour barrier in the height of the surface. The expansion gaps are covered with skirting profiles, transition strips and tube coverings. Remove all loose dirt from the surface.

# Maintenance

## AN OUNCE OF CARE IS BETTER THAN A POUND OF REPAIR

The right maintenance from the start is important. With the progress of time the floor becomes less demanding and increasingly stress resistant. Following the recommendations outlined below will keep your floor in tip-top condition:

- A good quality doormat in front or just inside a door will save the floor from abrasive mud and dirt. Plus help to reduce cleaning time. Do not forget to clean the doormats too.
- Loose dirt, dust and grit shall be removed by sweeping or vacuuming. Use a vacuum nozzle suitable for wood floors.

- Water causes swelling of the wood and can result in open joints and damage to the floor. Always remove spills and spots immediately with a slightly dampened cloth. Ensure adequate ventilation under floor pots with stick-on floor protectors or equivalent saucers.
- Low humidity or high temperatures, particularly during winter or on underfloor heating, can result in small open joints and fissures in the wood.

- A comfortable room environment has a relative humidity of about 50 – 60%. It must not drop below 35%. Air humidifiers during winter are recommended. On underfloor heating the use of thick carpets or other floor coverings must be avoided.
- Use casters or slip on floor protectors (no nail-on protectors) under all furniture. Rollers must be soft and meet EN 12529 "soft" (bi-colored rolls). Do not forget to clean the rollers too and exchange them when abrasion is visible. For office furniture chairs there are appropriate protection mats and their use is recommended.

- Strong and wrong cleaners, sand, dry microfibre, acid or alkaline substances (f.e. cement- or gypsum powder, wood ash, water from heating systems, moss remover etc.), solvents, stiletto heels, metal or metal wear can damage the finish and cause imprints, scratches and discoloration.
- For small mechanical damages there are easy to use repair sets available. Ask your dealer.
- For color spots or spills of paint never use sanding paper. There are several solutions available to kill these little mistakes without sanding the floor.
- Only use the following recommended maintenance products and follow the instruction of the suppliers.

## CARE AND CLEANING

Finishing, regular cleaning and renovation is done with FAXE products for oiled floors:

- for natural oiled or dark coloured surfaces: FAXE floor soap natural and FAXE maintenance oil natural
- for white oiled surfaces: FAXE floor soap white and FAXE maintenance oil white
- for SafeTOP® products: FAXE floor soap natural and FAXE maintenance oil SafeTOP®

Please always follow the instructions on the labels and the individual instruction for maintenance of SafeTOP® products.

## Finishing (first thing after installation) or renovation

Before finishing or renovation with maintenance oil the surface must be cleaned, regardless if brandnew or already used, with FAXE intensive cleaner, FAXE maintenance oil / FAXE Pflegeöl. SafeTOP® is applied with a disc machine and a tan pad. Remainings shall be polished away with an oil absorbing cloth.

## Regular cleaning

Wet cleaning is done with Faxe floor soap diluted in water 1:40. If there is more dirt use 2 buckets in a 2-step wiping process.





---

Instruction

---

# Clean & Care

# Timeline for clean and care

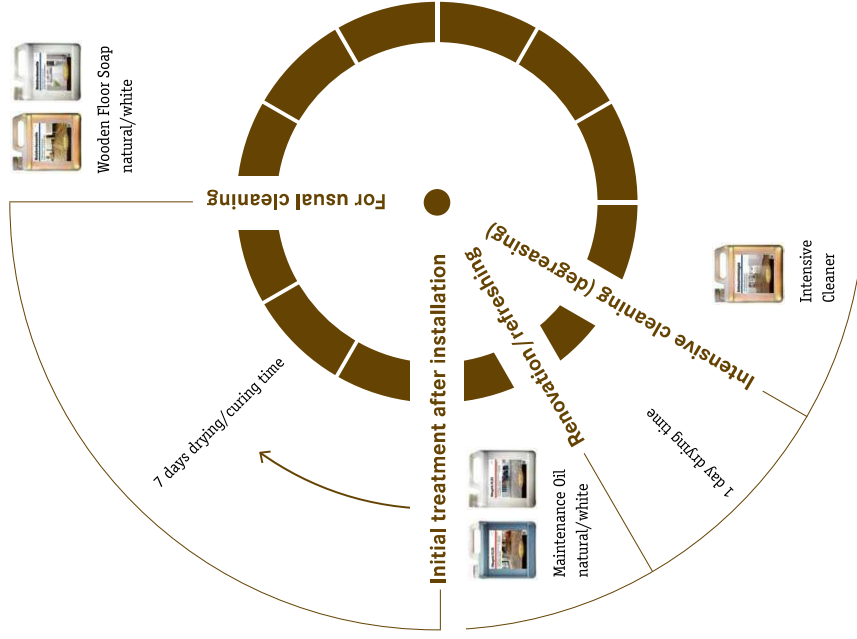

## CLEANING PRODUCTS QUICK FINDER

The surface treatment of flooring is a wide range. Not often is the time to study all instruction manuals to be updated with the current stand of technology. FAXE cleaning products are perfect for the usually existing flooring and parquet surfaces. To maintain a floor a correct care product is absolutely essential. Here our recommendation.

SURFACE	INITIAL TREATMENT always when oiled flooring is new installed + MAINTENANCE CARE renovation after basic cleaning	USUAL CLEANING additive for mop water	BASIC CLEANING before maintenance care
<b>SaieTOP®</b>	Only for renovation: <b>Maintenance Oil SaieTOP®</b>	<b>Wooden Floor Soap natural</b>	<b>Intensive Cleaner</b>
<b>Hard oil colorless + colored</b> (Except for white and extrawhite) (All oxidative curing) Residential area	With Rapid Mop: <b>Oilotion</b> With disk type machine: <b>Maintenance Oil natural</b>	<b>Wooden Floor Soap natural</b> <b>Oil Soap natural</b> <b>Active Care matt</b>	<b>Intensive Cleaner</b>
<b>Hard oil white + extrawhite</b> (oxidative curing) Residential area	With Rapid Mop: <b>Oilotion</b> With disk type machine: <b>Maintenance Oil white</b> Manufacturer specific cases: <b>Active Care white</b>	<b>Wooden Floor Soap white</b> <b>Oil Soap white</b> <b>Active Care white</b>	<b>Intensive Cleaner</b>
<b>Hard wax oil</b>	<b>Active Care</b>	<b>Active Care</b>	<b>Intensive Cleaner</b>
<b>Hard oil</b> Commercial area	Disk type machine: <b>Maintenance Oil natural</b>	<b>Active Care</b>	<b>Intensive Cleaner</b>
<b>UV-Oil</b> Engineered flooring	<b>Active Care</b>	<b>Active Care</b>	<b>Intensive Cleaner</b>
<b>Lacquers</b> Engineered flooring	<b>Active Care</b>	<b>Active Care</b>	<b>Parquet Cleaner</b>
<b>Design-Vinyl</b> (LVT - Luxury Vinyl Tiles)	Only for renovation: <b>Active Care matt</b>	<b>Vinyl Cleaner</b>	<b>Vinyl Cleaner</b>
<b>Linooleum</b>	Only for untreated linooleum: <b>Active Care/</b> <b>Active Care matt</b>	<b>Active Care/</b> <b>Active Care matt</b> In case of heavily soiled floor: <b>Vinyl Cleaner</b>	<b>Parquet Cleaner</b>

Video tutorials and support at  
[www.faxe.de](http://www.faxe.de)



Author: Thomas von Schreier. All details and specifications are done to the best of knowledge and state of the art. If necessary a test area should be prepared in advance. All rights reserved. Print, distribution and reproduction, also in parts needs the official authorization. F. W. Barn & Co. GmbH - FAXE Direct Import - Fuggerstrasse 25 - D-41352 Korschenbroich - info@faxe.de - www.faxe.de